

SSR-200

Safety systems Overturning

Certification CE

Product Code : F00176

EXAMPLES OF APPLICATIONS

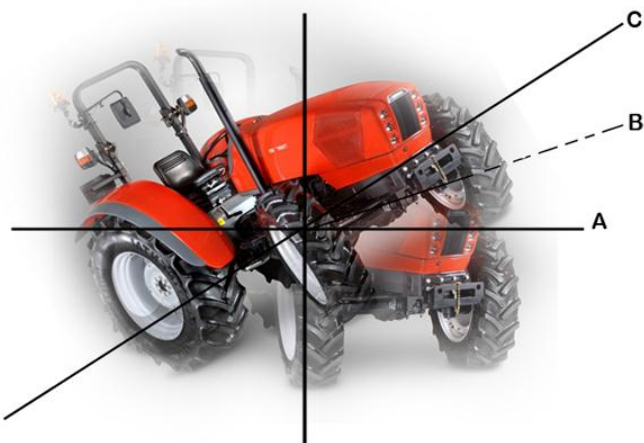

SIGNAL OUT FIRST ALARM SAFETY

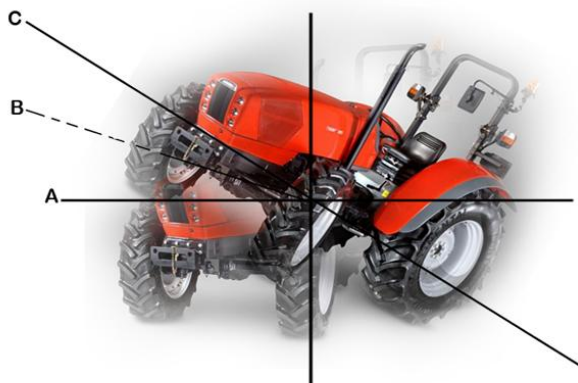
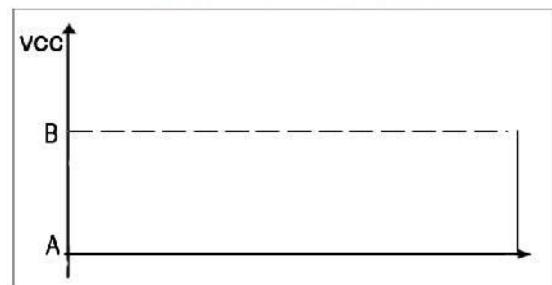

SIGNAL OUT ALARM SAFETY

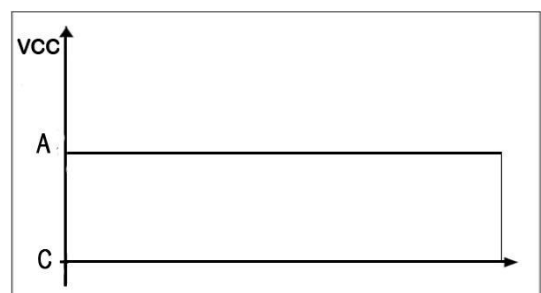

SSR-200

Safety systems Overturning

Like in the example brought back in the tractor up, the same technology can be applied on varied blots some, like Undercarriages Telescopic Elevators, Tractors and Scissors Platforms.



The Safety Systems of overturning applied on the Undercarriage Elevator gives the possibility of being able to control the cargo in elevation on slanted plans. Thanks to the continuous control of axes x and y of the machine in the event of overcoming of the prefixed angles of emergency, take part bringing back the cargo in an emergency position or stopping the operation.



In the Telescopic Tractors the Safety Systems of overturning monitors during the operativity of the machine the job angles. In the event of approach to the emergency angle the operator comes perceived with marks them acoustic visual. At overcoming of the emergency angles the vehicle comes stopped or brought back within the limits of the set up parameters of emergency.



In the Scissors Platforms the Safety Systems of overturning controls the efficiency of the machine through the job angles. In the event of approach to the emergency angle the operator comes perceived with marks them acoustic visual. At overcoming of the emergency angles comes limited the heights of job of the Platform.



SSR-200

Safety systems Overturning

WIRING SYSTEMS :

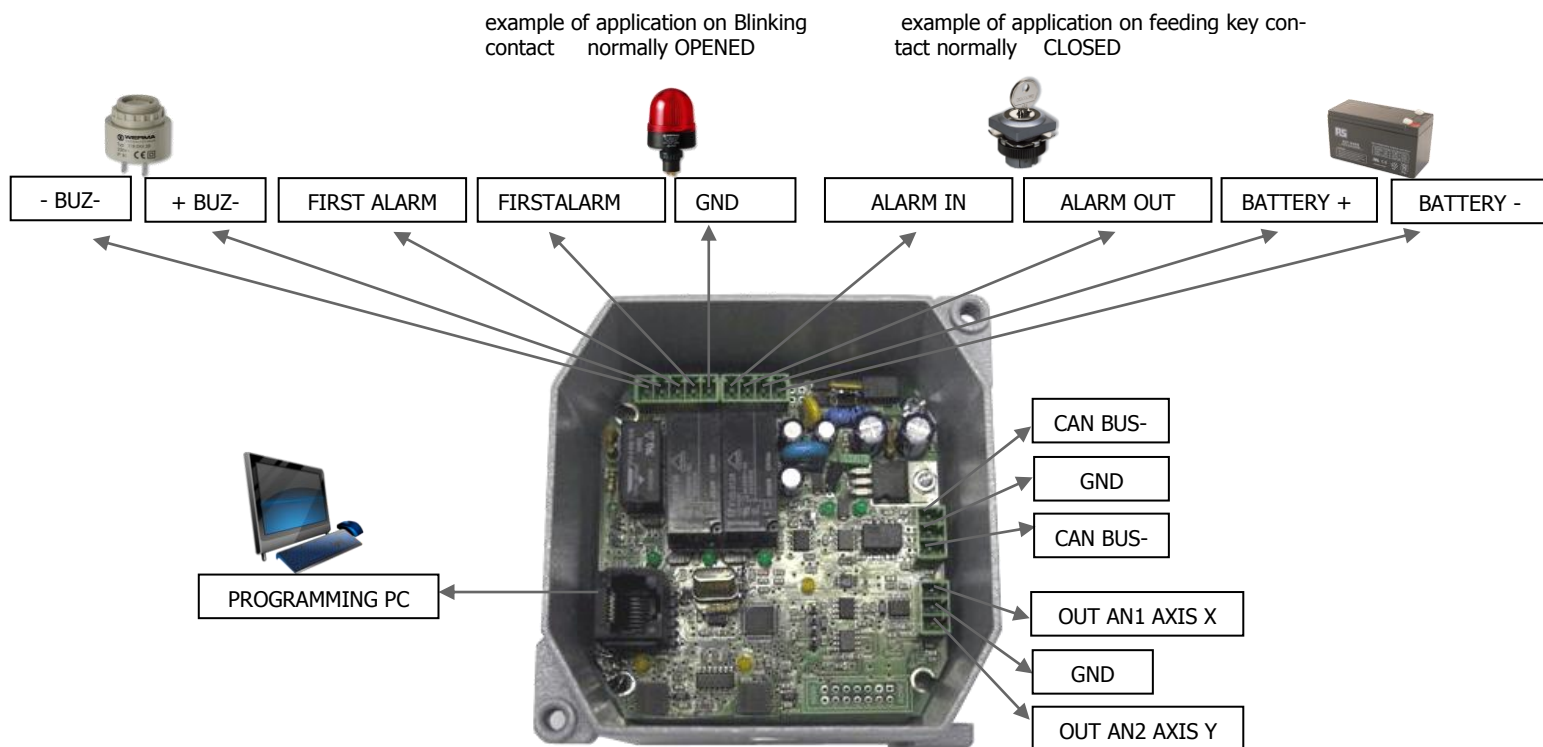

MECHANICAL CHARACTERISTICS at mm :

A = 86mm
 B = 80mm
 C = 06mm

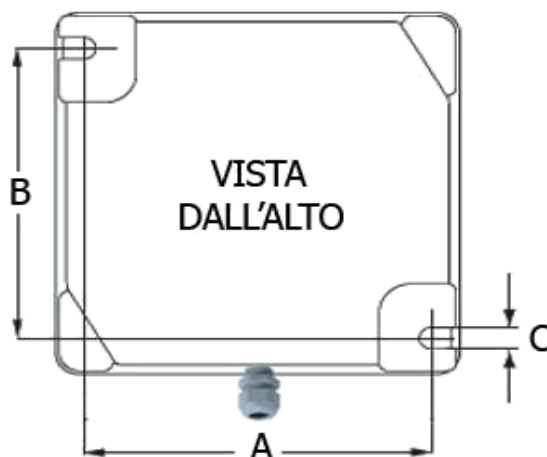

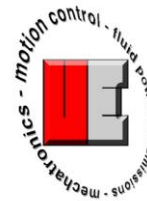

SSR-200

Safety systems Overturning

The company is responsible in no accidental error which might be found in this document and reserves the right to modify the description and the data without notice.

